

# ADVANCE NOTICE OF REVISION- SPORTSMAN

(This notice **supplements** all earlier notices)

## Section VI: Wing Assembly

**Page 130:** The Text under figure 67 was revised as follows: ~~Provide .75 clearance between rib & center of track.~~ Provide .30 minimum clearance from edge of track. Figure 67 was updated accordingly with 2 arrows and text .30 indicating this change.

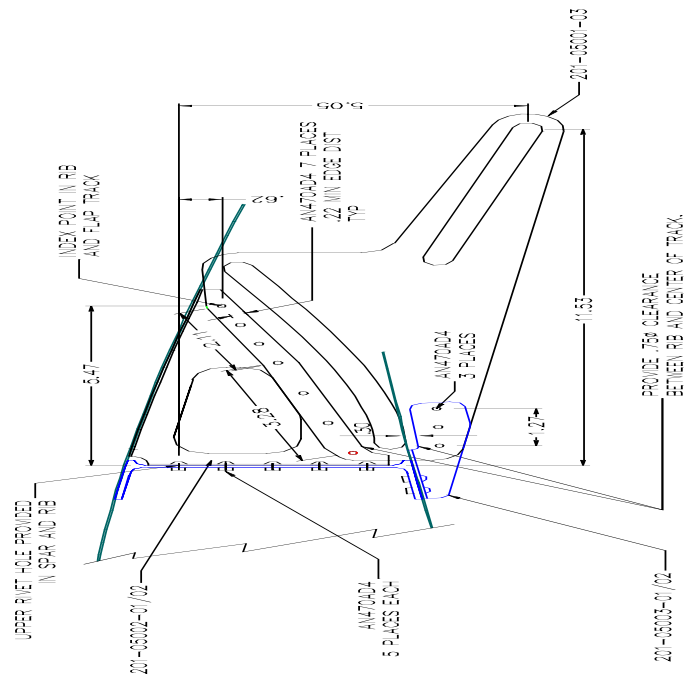

**Figure 67: Flap Track Assembly**

	REVISION: <p style="text-align: center;">-</p>	DATE: <p style="text-align: center;">11/17/2006</p>	PAGE: <p style="text-align: center;">1</p>
---	---	--	---

**Page 155:** Figure 83 was updated, the overall length of the flap track reinforcement was added 3.25.

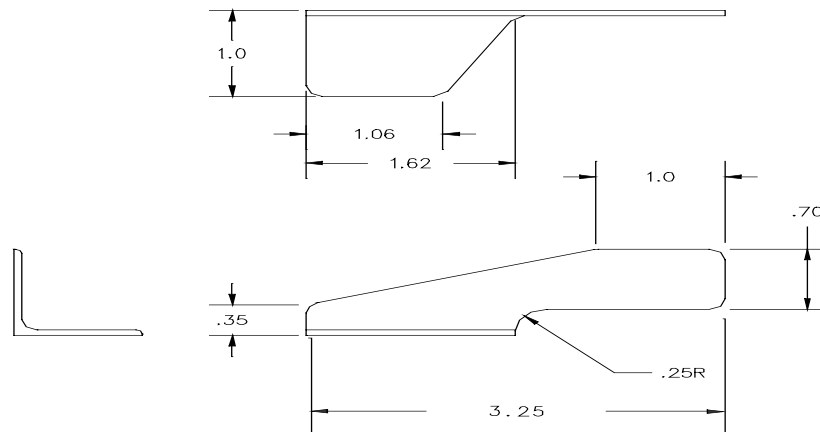

**Figure 83: Flap Track Reinforcement Angles**

## Section IX Systems Installation

**Main Parts List:** Part number 450-[42]

**Page 48:** Press the 3/16" X 1/2" roll pin [42] **pan-head screw** #10 X 7/16 [167.1] and **the self-locking nut**, 10-32 [108] into the hole at the upper end of the flap handle ratchet plate; this pin serves as a limit stop for the flap handle.

**Page 49:** Figure 20, Flap Handle Assembly, the text changed on figure to reflect the new parts listed above. (42 was modified)

# ADVANCE NOTICE OF REVISION

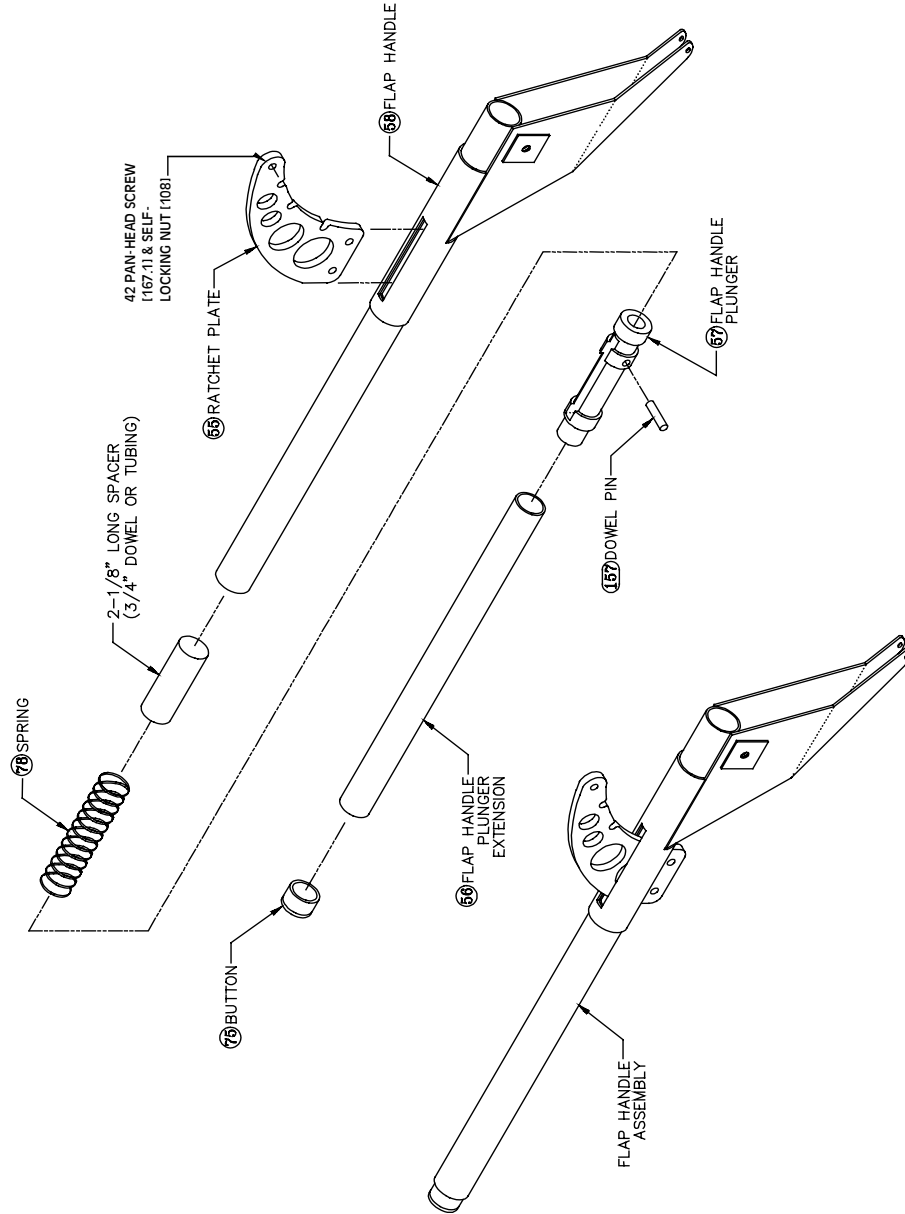

**Figure 20- Flap Handle Assembly**

	REVISION: -	DATE: 11/17/2006	PAGE: 3
---	----------------	---------------------	------------

**Page 158:** Effective immediately, the following new cable lengths will take affect for the four aileron crossover cables.

The affected section of the manual is Systems Installation (IX), pages 154-165. Please follow new cable lengths for proper installation. Refer to the tools and techniques section of the manual for fabricating the aileron crossover cable assemblies. After many hours of rigging of the flight controls in the Customer Assembly Center (CAC), the left and right aileron crossover cables and the left and right aileron secondary crossover cables, can be pre-fabricated prior to installation. For assistance, contact the Technical Support department Monday through Thursday, 2pm –4pm Pacific Standard Time (PST).

618-01014-01 LH Aileron Crossover: 140-1/4

618-01015-01 RH Aileron Crossover: 155-13/16

618-01013-01 LH Aileron Secondary: 176 3/4

618-01013-02 RH Aileron Secondary: 176-1/8 (made from the second 618-01013-01 cable)

## ADVANCE NOTICE OF REVISION

**Page 201:** The dimensions for the fuel sump drain holes were relocated to match fuel tank sumps; Figure 114 has been revised as follows: Drain hole locations with hole saw: changed from 3/4" to 1". B+D Trike changed from 12-1/6" to 12.45", A+C changed from 3-5/8" to 3.7". Step 65, the text changed in the last paragraph, 2<sup>nd</sup> sentence - Mark one or both of the hole locations and drill a 3/4" 1" hole using either a piloted hole saw or a Unibit.

	REVISION: -	DATE: 11/17/2006	PAGE: 5
---	----------------	---------------------	------------

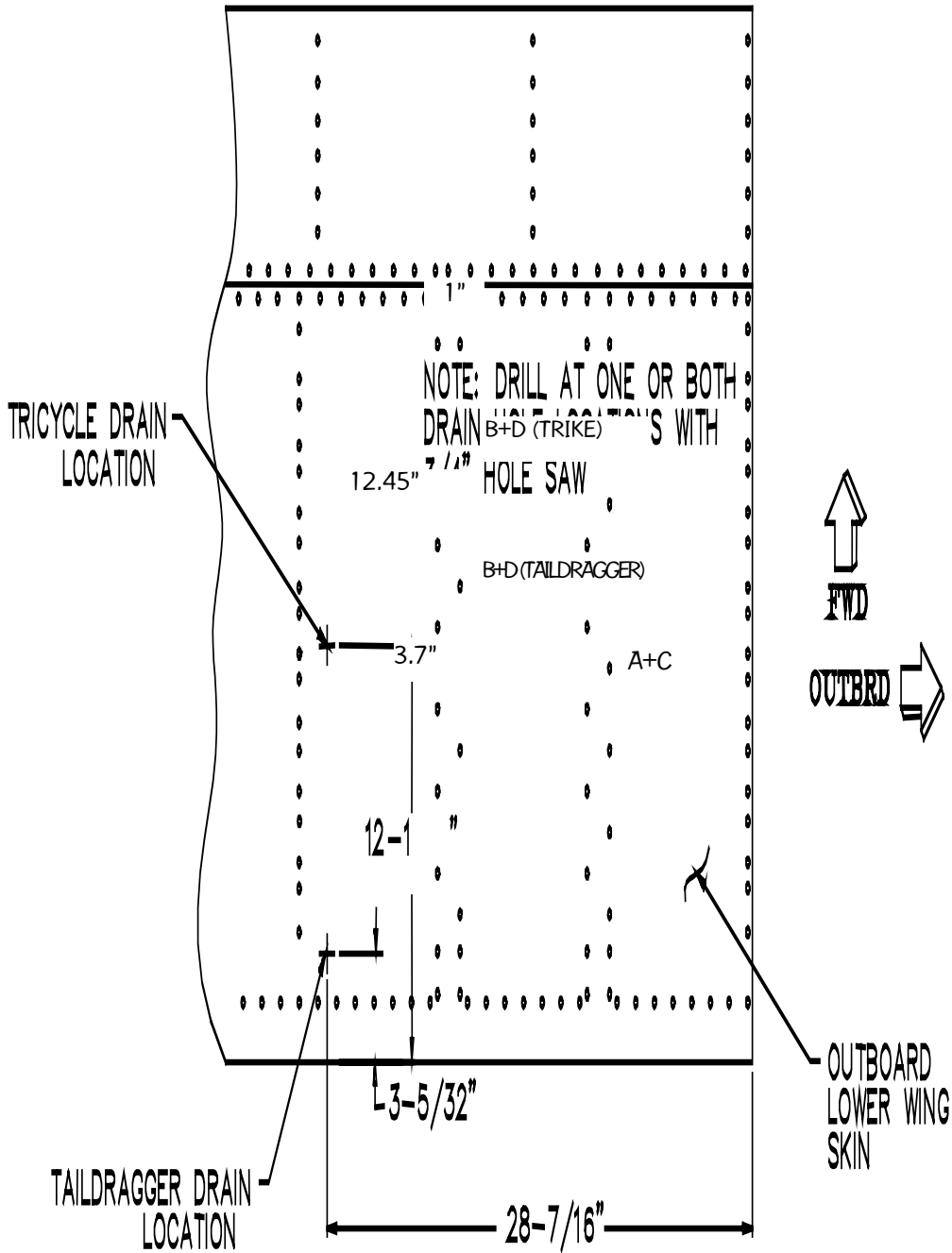
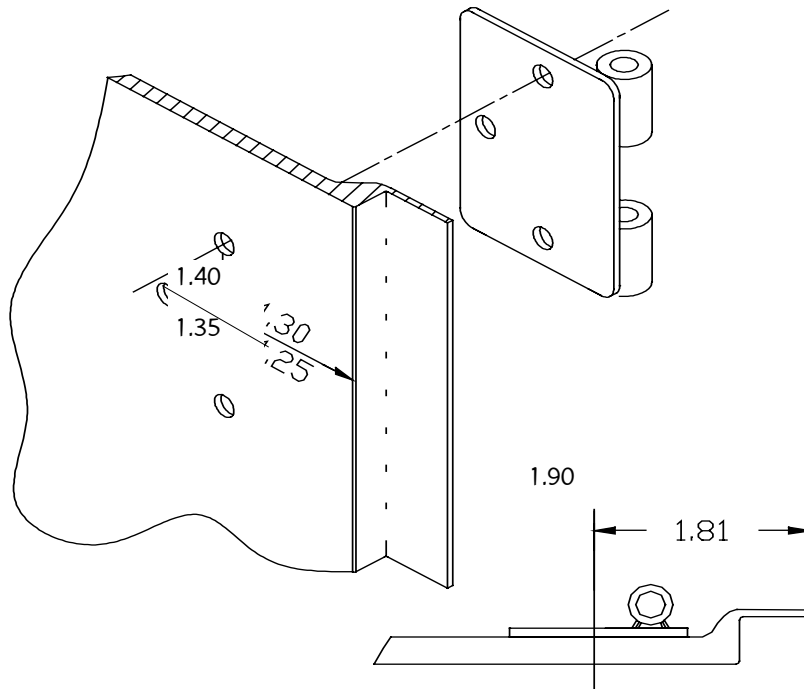

**Figure 114: Preliminary Sump Drain Hole Locations**

# ADVANCE NOTICE OF REVISION

## Section X: Final Assembly

**Page 240:** Figure 133.1 dimensions changed from 1.30 to 1.40, 1.25 to 1.30, 1.81 to 1.90. The text changed in Step 124 - Keep them connected to each other with the 24" rod. The important dimension is the ~~1.30/1.25~~ 1.40/1.35, but since you must drill from the inside you must measure from the edge of the 1/2" flange, resulting in a ~~1.8"~~ 1.90"



**Figure 133.1: Location of the Forward Hinge Half on the Fuselage**

**Page 268:** all text removed for Step 137.1

### ***Step 137.1: Wing Fold Recess Covers***

Before you go and fold your wings, be advised that the inboard flap tracks will contact the fuselage before the wings can be fully folded. For this reason there is a recessed flange on the outer fuselage surface just forward of the upper aft strut attach arm as referenced in Figure 119 in the Systems section of the manual.

In order to fold the wings, you must trim the inside of the recess until you have approximately 5/8" flange left. This will make room for the flap track to pass through the shell and allow the wings to be folded to their full extent. Then install the flap track

	REVISION: -	DATE: 11/17/2006	PAGE: 7
---	----------------	---------------------	------------

~~recess cover [233] over the flange. The covers come with a slight curvature to them, which approximates the curvature of the fuselage. The cover needs to be trimmed to shape and then it attaches to the recessed flange (forward side) using one AN507 8R8 screw and one K1000 8 nutplate. Refer also to the instructions included in the wing fold brace kit regarding the installation of the recess cups on the inside of the fuselage.~~

~~If you decide **not** to fold your wings, you can fill in the recess with a structural fill and then body finish over that. You may also chose to install the cover as described above.~~

**Completed:** [ ]

Page 9, Parts list-part removed.

194	<del>Flap track recess cover</del> Part Removed	2	<del>101-00040-01</del>
-----	---	---	-------------------------



# ADVANCE NOTICE OF REVISION

**This page intentionally left blank**

	REVISION: -	DATE: 11/17/2006	PAGE: 9
---	----------------	---------------------	------------